

INDOOR CYCLING BIKE SENSOR INSTRUCTIONS

TOOLS



1 X MULTI TOOL



MAGNET

INSTRUCTIONS



1
Locate the sensor on
the left side of the
bike



2
Using the multi tool
remove the screw

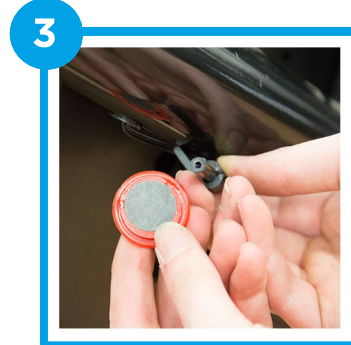

3
Use any kind of magnet
to run over the sensor



4
Check the monitor to
see if the digits change

ADVICE

Make sure to unscrew the right pedal anticlockwise and the left clockwise.

Any kind of magnet can be used for the test, for example a fridge magnet.

If there are no readings from your monitor before the test this could indicate the sensor is too far from the wheel, after the magnet has been ran over the sensor if there are still no readings this may indicate that it is a faulty sensor.